

# FANTASY Series Projection Screen

China Well-known Trademark

**GRANDVIEW**  
GRANDVIEW REPRODUCING GENUINE COLORS

## Universal Bracket

Suitable for either wall mount, ceiling mount or ceiling hang. The bracket can slide horizontally at the back of the casing to match different installation positions.

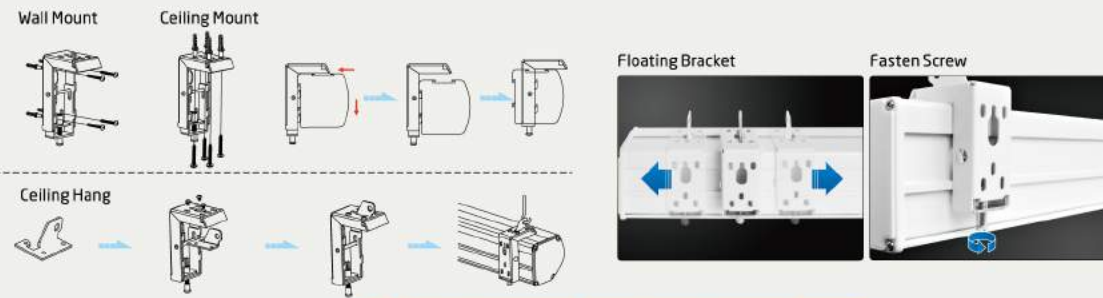

## Standard Accessories

Motorized Screen and Manual Screen



Intelligent Motorized Screen



## Optional Accessories for Intelligent Motorized Screen

### Power Relay

The emitter is installed at the projector end and the receiver is connected to the "EXT IR" plug on the screen, when the projector is triggered on/off the screen would open/close automatically



### RS485 Wall Switch

RS485 Wall Switch is an external screen controller, integrated with RS485 and USB interface, it can be connected to the "EXT CTRL" slot on the screen end to control the screen.



## Specification

### Intelligent Motorized Screen FA-MIxxx / Motorized Screen FA-Mxxx

Format	Specification (inch)	Viewing Area (W x H)	A	B3	Package (L x H x W)	Net Weight (Kg)	Power (voltage 220v)
4:3	84	1710 x 1280	1513	80	1960 x 96 x 91	10.5	115W
	100	2030 x 1524	1757	80	2280 x 96 x 91	13.8	115W
	120	2400 x 1800	2031	80	2650 x 96 x 91	15.3	115W
	150	3050 x 2286	2637	80	3364 x 126 x 120	29.4	115W
16:9	92	2030 x 1145	1948	650	2280 x 96 x 91	13.8	115W
	100	2214 x 1245	1948	550	2464 x 96 x 91	14.5	115W
	106	2340 x 1320	1973	500	2584 x 96 x 91	15.1	115W
	120	2656 x 1494	2047	400	2906 x 96 x 91	14.3	115W
	150	3320 x 1867	2372	300	3636 x 126 x 120	24.1	250W

### Manual Screen FA-Pxxx

Format	Specification (inch)	Viewing Area (W x H)	A	B3	Package (L x H x W)	Net Weight (Kg)	Power
4:3	84	1710 x 1280	1528	80	1864 x 93 x 79	8.5	--
	100	2030 x 1520	1793	80	2204 x 93 x 79	10.0	--
	120	2338 x 1755	2008	80	2508 x 93 x 79	13.0	--
	150	2817 x 2110	2368	80	2992 x 96 x 91	17.6	--
16:9	92	2030 x 1145	1838	500	2204 x 93 x 79	10.0	--
	100	2214 x 1245	1918	500	2388 x 93 x 79	11.0	--
	106	2340 x 1320	1993	500	2508 x 93 x 79	11.8	--
	120	2656 x 1494	2072	400	2831 x 96 x 91	15.8	--

- Note:
1. Unremarked measurements are default to be MM.
  2. Side borders B1 are both 50mm.
  3. For recess-ceiling installation design, the length/width/height of the groove need to be added by 100mm/60mm/60mm respectively.
  4. Above parameters could be changed due to product improvement.

## 2D-View

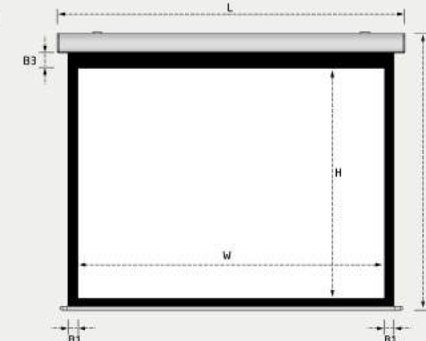

## End Cap View

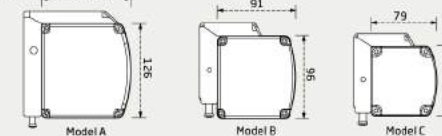

Forhandler:  
AV-Concept ApS  
Tlf: 30321889  
Mail: info@av-concept.dk  
www.av-concept.dk



**GRANDVIEW**

GRANDVIEW SCREEN ( CANADA ) CO., LTD.  
ADD: #11-3751 North Fraser Way, Marine Way Business Centre,  
Burnaby, BC, Canada V5J5G4  
TEL: 1-604.412.9777 FAX: 1-604.412.9796  
http://www.grandviewscreen.ca

GRANDVIEW CRYSTAL SCREEN CO., LTD.  
Add: Federal Industry Zone, NO.363, Yushan Road W.  
Shatou, Panyu, Guangzhou, Guangdong Prov., China  
Tel: 020-84899499 Fax: 020-84805299  
http://www.grandviewscreen.com

# FANTASY Series Projection Screen

Manual Screen with Speed Reduction  
Motorized Screen  
Integrated Motorized Screen



### Fabric Features

- Last-long Flatness**  
With four layer structure including Fiberglass, Stretchness less than 1% which ensures the last-long flatness.
- Color Accuracy**  
The reflection light are evenly distributed with less than 60K difference between incident angle and reflection angle.
- Sophisticated Images**  
Engraved with optical microgroove on the surface, with resolution more than 125 line pairs per mm, which ensures the sharpness of the projected images.
- Wide Color Range**  
With high contrast processment, while maintaining the color accuracy and color range is widely presented to provided a more vivid image.

**Structure**

<b>WM</b> Matte White	<b>160°</b> Viewing Angle	<b>1.0</b> Gain	<b>Fireproof</b>	<b>Environmental Friendly</b>	<b>Anti-Hold</b>	<b>Waterproof</b>	<b>Washable</b>
<b>GM</b> Matte Gray	<b>160°</b> Viewing Angle	<b>0.8</b> Gain	<b>Fireproof</b>	<b>Environmental Friendly</b>	<b>Anti-Hold</b>	<b>Waterproof</b>	<b>Washable</b>
<b>GB</b> Glass Beaded	<b>70°</b> Viewing Angle	<b>2.5</b> Gain	<b>Fireproof</b>	<b>Environmental Friendly</b>	<b>Anti-Hold</b>	<b>Waterproof</b>	

Forhandler:  
AV-Concept ApS  
Tlf: 30321889  
Mail: info@av-concept.dk  
www.av-concept.dk

**Uni-body Aluminum Casing**

**Suitable with Tubular Motor**

- \* Smooth Operation
- \* Accurate Positioning
- \* Low Noise ( <math>\leq 45\text{dB}</math>)
- \* Durable

### Fantasy Motorized Screen

- In-line Switch with direct control and high stability
  - Optional with IR / RF remote control
- 

### Optional External Remote Control System



- **External RF Remote Control sets**
  - \*The control distance can be 25meters, no direction restrains.
  - \*The motor is equipped with a "delayed action"and "1 minute disconnected" mechanism.
  - \*Button control design with "up" "stop" "down" function.
  - \*Micro-adjustment function design.
  - \*Ultra low power consumption, energy saving.
  - \*With learning function and universal design, the remote controller can be easily replaced even lost.
- **External IR Remote Control sets**
  - \*The control distance is 8 meters, control range is + -60 degrees.
  - \*The motor is equipped with a "delayed action"and "1 minute-disconnected" mechanism.
  - \*Preferred encoding combination, with anti-jamming design.
  - \*Button control design with "up" "stop" "down" function.
  - \*Micro-adjustment function design.
  - \*Ultra low power consumption, energy saving.
  - \*With Manual control design, easy to use.

## FANTASY Series Projection Screen



### Fantasy Manual Screen with Speed Reduction

- **Limitless Positioning**  
With Limitless Positioning Structure, the screen can be stopped by holding the handle for 3 seconds at any position.
- **Slow Retraction**  
With Slow Retraction System to allow the screen retracting back slowly within 8 seconds, which can prevent the safety issue cause by lower bar hitting casing.
- **Wrinkle Free**  
When the screen is fully retracted the positioning system is lock off and the fabric is not stretched by the spring system, which can prevent the wrinkle cause by long time stretchness from the spring system.

**Decelerating and Locking Mechanism**

Patent No.:  
China: ZL200510100943.2 U.S.: US7706067 Germany: 202006009545.4  
France: 0606763 Japan: 3126248

Open Status      Lock Status

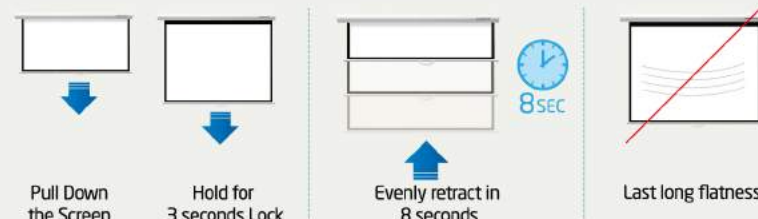

### Fantasy Integrated Motorized Screen

In-built with IR control function and designed with interfaces for wall switch and external central control to control the screen remotely and intelligently.

